

SCALE: 1" = 60'

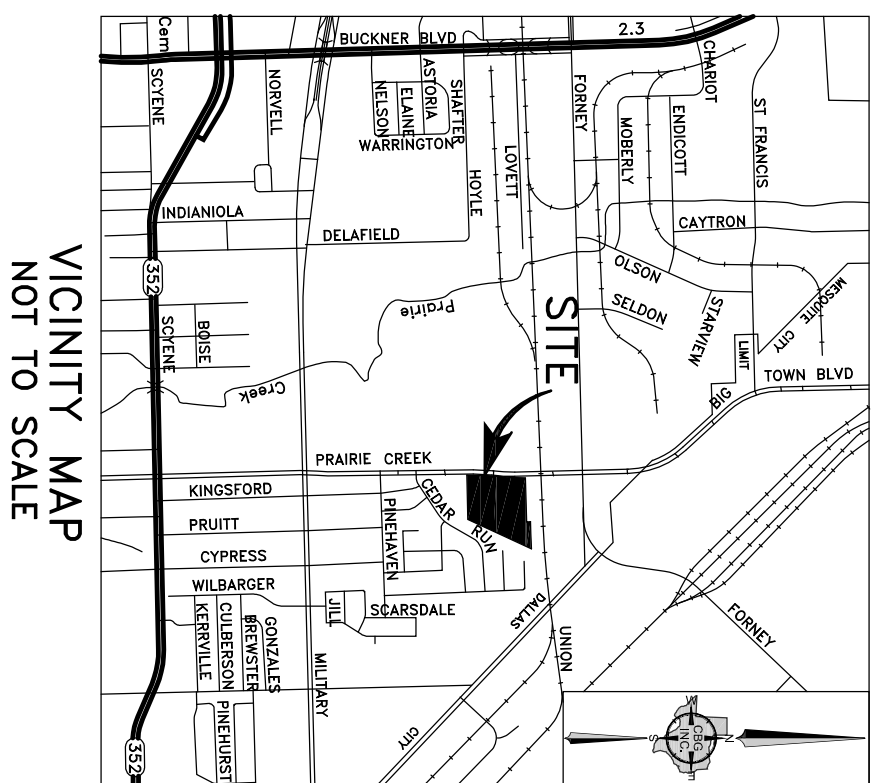

DALLAS POWER & LIGHT COMPANY,
A TEXAS CORPORATION
VOL. 5854, PG. 441
D.R.D.C.T.

DALLAS POWER & LIGHT COMPANY,
A TEXAS CORPORATION
VOL. 5854, PG. 441
D.R.D.C.T.

DALLAS POWER & LIGHT COMPANY,
A TEXAS CORPORATION
VOL. 5854, PG. 439
D.R.D.C.T.

DALLAS POWER & LIGHT COMPANY,
A TEXAS CORPORATION
VOL. 5854, PG. 439
D.R.D.C.T.

STATE PLANE
COORDINATES
N=6970.324.27
E=2533.288.22

R=9186.34', L=188.73'
D=140°58'
CH=187°37'39"E 188.73'

JOHN LEEPER SURVEY
ABSTRACT 794

JOB BADGELEY
ABSTRACT 75

STATE PLANE
COORDINATES
N=9804.539
E=2532.873.00

CITY OF DALLAS
VOL. 94024, PG. 3984
D.R.D.C.T.

CITY OF DALLAS
VOL. 86077, PG. 5704
D.R.D.C.T.

PRELIMINARY PLAT

VILLAS ON PRAIRIE CREEK ADDITION

LOTS 1 THROUGH 41, BLOCK A/6787
LOTS 1 THROUGH 23, BLOCK B/6787
LOTS 1 THROUGH 20, BLOCK C/6787
539,184 SQ.FT. / 12.378 ACRES
BEING A TRACT OF LAND SITUATED IN THE
JOB BADGELEY SURVEY, ABSTRACT NO. 75
CITY OF DALLAS, DALLAS COUNTY, TEXAS
CITY PLAN FILE NO. S178-010

LEGEND:

CM CONTROLLING MONUMENT

IRF IRON ROD FOUND WITH A YELLOW CAP

IRF YC IRON ROD FOUND WITH A YELLOW CAP

A.C.S. 3 INCH ALUMINUM DISK STAMPED "VOPCA & RPUS
5513" SET OVER A 1/2" IRON ROD SET
VOLUME

VOL. PAGE

PG. INSTRUMENT NUMBER

INST. NO. SQUARE FEET

SQ. FT. RIGHT-OF-WAY

R.O.W. DEED RECORDS, DALLAS COUNTY, TEXAS

M.R.D.C.T. MAP RECORDS, DALLAS COUNTY, TEXAS

O.P.R.D.C.T. OFFICIAL PUBLIC RECORDS, DALLAS COUNTY, TEXAS

GENERAL NOTES

1) COORDINATES SHOWN HEREON ARE TEXAS STATE PLANE COORDINATE SYSTEM, NORTH
CENTRAL ZONE, NORTH AMERICAN DATUM OF 1983 ON GRID COORDINATE VALUES, NO SCALE
AND NO PROJECTION.

2) THE PURPOSE OF THIS PLAT IS TO CREATE 84 RESIDENTIAL LOTS AND 2 COMMON AREAS.

3) LOT TO LOT DRAINAGE WILL NOT BE ALLOWED WITHOUT ENGINEERING SECTION APPROVAL.

4) ANY STRUCTURE NEW OR EXISTING MAY NOT EXTEND ACROSS NEW PROPERTY LINES.

OWNER: GREENLEAF VENTURES, L.L.C.
A TEXAS LIMITED LIABILITY COMPANY
VICTOR TOLEDO, MANAGER
DALLAS, TEXAS 75201
PHONE: 214-755-9805
E-MAIL: VTOLEDO@GVAHOU.COM

PLANNING & SURVEYING
Main Office: 12095 Shiloh Road, Ste 200
Dallas, TX 75228
P: 214.349.0265
F: 214.349.0266
D: 214.349.0266
www.cbgsurveying.com
www.cbgsurveying.com

SCALE: 1"=60' / DATE: OCTOBER 16, 2017 / JOB NO. 1703490 / DRAWN BY: YP